

CERTIFICATE OF LAND

File No.

Date:

Certified that the land measuring 34,552 is owned by the Govt. land and Private land by way of Gift Deed (In case of allotment of land, if it is not perpetual, periodicity of allotment to be mentioned from _____ to _____).

It is further certified that owner of the land has leased the said land to (In case of lease /sub- lease only (Name of the School/Society/Trust/Company under Section 8 of companies Act, 2013) fully described in the schedule mentioned hereinafter with the following details for a period of _____ years from _____ to _____.

SL	Particulars	Details
1.	Plot No. (s)/ Survey No. (s)/Khasra No. (s)/Khata No.(s)/Khatauni No.(s)	16/2,20p
2.	Name of street/village, Sub Division, District and State	Ekalavya Model Residential School Dumbriguda, adjacent toNH 516E, VIII+ PO - Dumbriguda, Alluri Sita Ramaraju Dist, Andhra Pradesh - 531151

It is certified that the said entire land comprise of a single contiguous plot of land. It is further certified that EMRS Dumbriguda, adjacent toNH 516E, VIII+ PO - Dumbriguda, Alluri Sita Ramaraju Dist, Andhra Pradesh - 531151 run by name of National Education Society for Tribal Students (Society / Trust / Company under Section 8 of companies Act, 2013) is located on the said plot of land.

THE SCHEDULED OF LAND ABOVE REFERRED TO

All that piece and parcel of land measuring 34,552 (area of land in square meters) situated in Sy.No16/2,20p as Ekalavya Model Residential School Dumbriguda, adjacent toNH 516E, VIII+ PO - Dumbriguda, Alluri Sita Ramaraju Dist, Andhra Pradesh - 531151 and bounded as follows:

North : Sy.No.15/10 and 20
 East : Sy.No. 17 and 19 existing NH 516E Road
 West : Sy.No.20 Hill
 South : Sy.No.16/3 (pending at High court for boundary Dispute)

DM/ ADM/ SDM/ TEHSILDAR/ NAIB TEHSILDAR/ REGISTRAR/ SUB- REGISTRAR/EQUIVALENT LAND AUTHORITY

(Stamp and Signature of the land authority)

H.TRIVENI

TAHSILDAR

DUMBRIGUDA

ASR Dist.

* The filled up certificate should be either in Hindi or English. If it is issued in vernacular language, translated notarized version in English be uploaded along with the original vernacular certificate as a single pdf.

Submitted:

To
The Tahsildar,
Dumbriguda

Sub: Dumbriguda (m)- Dumbriguda (v)- Sy. No. 16-2,3 and 20part-Representation from the Principal, Ekalavya School, Dumbriguda for the land possession certificate- field inspection conducted and report submitted- reg.

- Ref: 1. Representation from the Principal, Ekalavya School, Dumbriguda.
2. Instructions of the Tahsildar, Dumbriguda.

Kind attention is invited to the reference cited.

I submit that in the ref 1st cited, Principal, Ekalavya School, Dumbriguda has sent a representation and requested to issue land possession certificate for the existing Ekalavya School in Dumbriguda village, Dumbriguda mandal for granting CBSC affiliation. In this regard as per the instructions of the Tahsildar, Dumbriguda I inspected the said land along with the school staff and conducted a survey.

Further submit that as per the field demarcation the existing school and Hostel buildings are covered in Sy No. 16-2 and 20part of Dumbriguda village, Dumbriguda mandal for an extent of Ac 8.54 cts or 34,552 sq.mts. (part of land is covered with Hill and bushes)

Further, Sy No. 16-3 of extent Ac 2.09 cts of land is handed over to them in the year 2015, but at present a writ petition is pending before the H'ble High Court of Andhra Pradesh, therefore which is does not included at present.

The schedule property lies with the following boundaries.

North: Sy No. 15-10 and Sy. No. 20 of Dumbriguda village

East: Sy No. 17 & 19 Existing NH516E road

West: Sy. No. 20 Hill

South: Sy. No. 16-3 of Dumbriguda village

The above-mentioned details have been earmarked in FMB sketch and attached along with this report.

I submit this report for your kind perusal and further necessary action.

Yours faithfully

28/04/26

Mandal Dy. Surveyor

Dumbriguda

H. Shivani
TAHSILDAR
DUMBRIGUDA



isabha palin
Padaru

Field No. 16

Village No 247
Area 3

Name Dumbbriguda
Hectares 33
Area

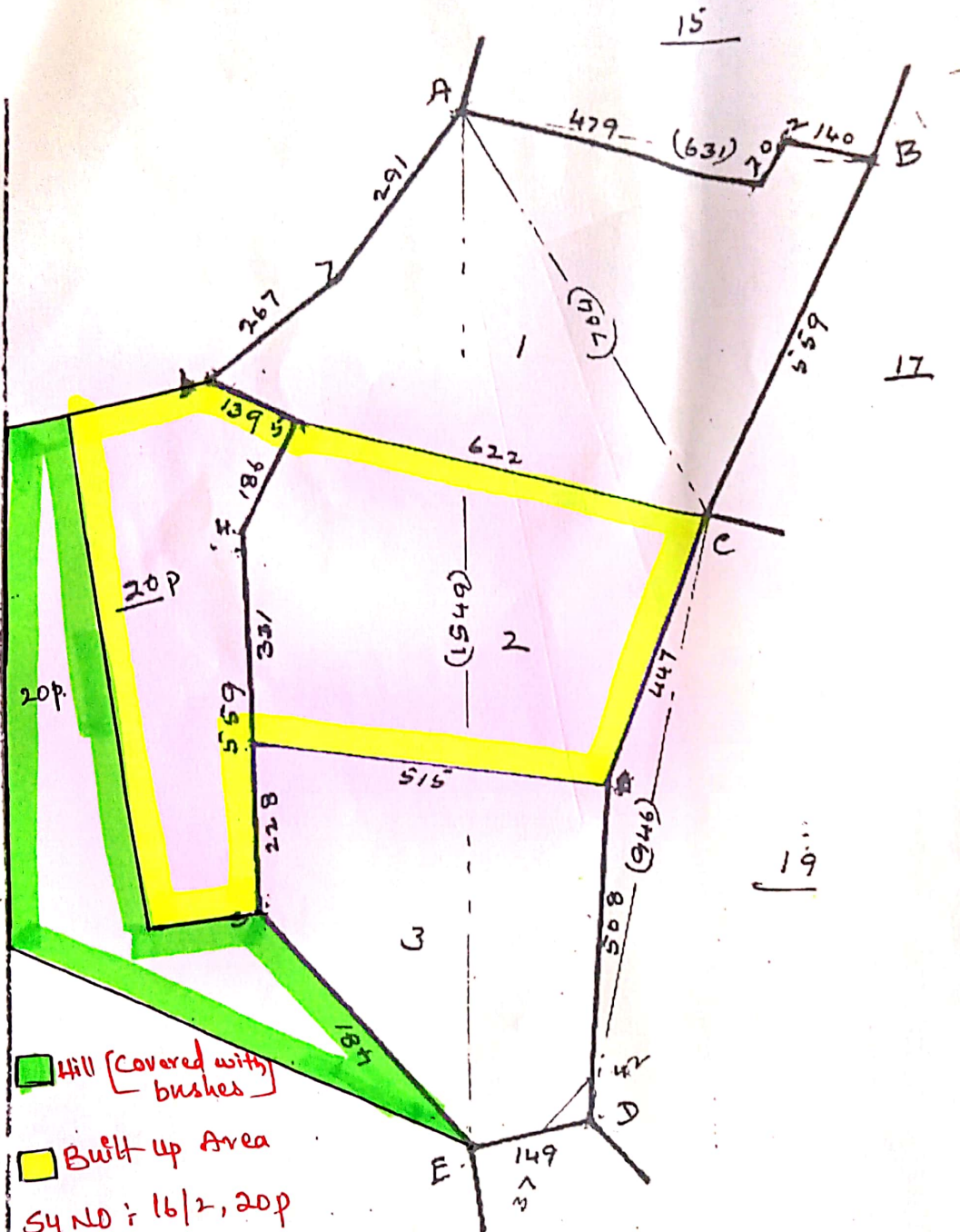

■ Hill (covered with bushes)
■ Built up Area
 Sy NO : 16/2, 20p
 Extent : Ac. 8.54

Prepared by
 T. Sadasana Rao
 11-4-79 108

H. Thiriveni
 TAHSILDAR
 DUMBRIGUDA

Mo

Compd by

P. Kumar

	A		
	704		
	287	473	B
	C		
	D		
	946		
	443	61	8
	E		
	1018		
	78	128	D
	A		
	1549		
7	156	1300	
6	370	1147	
5	240	1098	
	948	266	E
4	316	929	
3	307	370	
	E		
	B		
	631		
2	21	495	
	475	46	8
	A		

Scale: One Centimeter = Chain of 20 Meters.

S. Muni Ratnam
21-12-79